

Thallo & Thallo S

User manual

Introduction

Enlarging the battery capacity to 3000mAh and increasing the compatible external battery type to both 18650 and 21700, Thallo and Thallo S are to reshuffle the pod mod series hand in hand, extending the standby time and heightening the happiness when vaping. The kit comes with a Thallo RPM 2 pod and two replaceable RPM 2 coils; RPM 2 DC 0.6Ω MTL Coil and RPM 2 Mesh 0.16Ω Coil, respectively focusing on accelerating the heating and producing a plump taste to keep pace with the power forceful to 80W(Thallo) / 100W (Thallo S). Innovation keeps changing the vaping experience!

Thallo (Built-in 3000mAh)

The Kit Includes

Standard Edition

- 1 x Thallo Device (3000mAh)
- 1 x Thallo RPM 2 Pod (5ml)
- 1 x RPM 2 Mesh 0.16Ω Coil
- 1 x RPM 2 DC 0.6Ω MTL Coil
- 1 x Type-C Cable
- 1 x User Manual

2ml Edition

- 1 x Thallo Device (3000mAh)
- 1 x Thallo RPM 2 Pod (2ml)
- 1 x RPM 2 Mesh 0.16Ω Coil
- 1 x RPM 2 DC 0.6Ω MTL Coil
- 1 x Type-C Cable
- 1 x User Manual

The Kit Includes

Thallo S (External Single 21700/18650 Battery)

Standard Edition

- 1 x Thallo S Device
- 1 x Thallo RPM 2 Pod (5ml)
- 1 x RPM 2 Mesh 0.16Ω Coil
- 1 x RPM 2 DC 0.6Ω MTL Coil
- 1 x Type-C Cable
- 1 x User Manual

2ml Edition

- 1 x Thallo S Device
- 1 x Thallo RPM 2 Pod (2ml)
- 1 x RPM 2 Mesh 0.16Ω Coil
- 1 x RPM 2 DC 0.6Ω MTL Coil
- 1 x Type-C Cable
- 1 x User Manual

Specifications

Thallo (Built-in 3000mAh)

- Size: 123.65*37.7*30mm
- Weight: 148g
- Battery Capacity: 3000mAh
- Power Range: 1W-80W
- Standby Current: <100uA
- Input Voltage: 3.3V-4.2V
- Output Voltage: 0.8V-4.0V
- Resistance Range: 0.15Ω-2.5Ω
- Charging Voltage: 5V±0.2V
- Charging Current: Max 1.2A
- Overcharge Voltage: 4.3V±0.05V
- Overcharge Current: 2A±0.6A
- Over-discharge Voltage: 2.4V±0.05V

English / 01

Thallo S (External Single 21700/18650 Battery)

- Size: 129.1*37.5*31.4mm
- Weight: 107g (Single 18650/21700 battery not included)
- Power Range: 5W-100W
- Standby Current: <120uA
- Input Voltage: 3.3V-4.2V
- Output Voltage: 0.5V-4.0V
- Resistance Range: 0.15Ω-2.5Ω
- Charging Voltage: 5V±0.2V
- Charging Current: Max 1.4A

Verification

Note: Please carefully keep the AB verification codes on the package. AB verification codes are required and will be used in product verification and after-sales service.

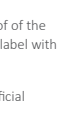

1. Please download and install IPVS Tour APP.
2. Please refer to <https://www.smoktech.com/new-anti-counterfeiting-system>, and then follow the steps described in THE NEW ANTI-COUNTERFEITING SYSTEM to verify your product.
3. Only the verified product can get warranty service.
4. If you have any questions, please contact SMOK via e-mail, phone or our website to get more help.

Warranty

Thallo/Thallo S Warranty Period: 6 Months from the Purchase Date.

Within the 6 Months, some items may not be eligible for service due to misuse, damage, or other failures caused other than by manufacturer defects or premature failure. Please contact SMOK Authorized Vendor for more information and terms of service.

The Warranty Card should be filled out by the vendor as proof of the store warranty. Please carefully keep the anti-counterfeiting label with the product packaging if you need a factory warranty.

For more warranty policies and processes, please visit our official website: <http://www.smoktech.com/support/>.

SMOK Hearty Service

If you need after-sales service, please send e-mails to support@smoktech.com.

Safety Instructions

- 1) Charge the battery indoors only;
- 2) Do not use any power source that does not have a local legal manufacturing license.

English / 02

Components

The figure below is based on the Thallo S.



- 1 Mouthpiece
- 2 Pod
- 3 Coil Head
- 4 Airflow System
- 5 Fire Key
- 6 0.96inch Display
- 7 UP/DOWN Button
- 8 Type-C Port
- 9 Battery Cap

The illustration is for reference only, please refer to the specific item.

English / 03

Preparation before use

- (1) Battery make sure the battery you're using corresponds with the BATTERY WARNING CARD. (Thallo S only)
- (2) Before vaping, please make sure the pod is filled with enough e-juice.

Battery Installation (Thallo S only)

- (1) Slide and open the battery cover as the picture shows;
- (2) Place a single 21700/18650 battery into the device according to the correct directions;
- (3) Close the battery cover



English / 04

Operation Guide

Thallo / Thallo S Device

1. Battery Type Option (Thallo S only)

After changing the battery and first starting, fast press Fire Key 5 times to turn it on. Press the UP or DOWN button to select the battery type. If it were 18650 battery, the max output is 80W; if it were 21700 battery, the max output is 100W.

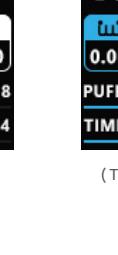

2. Power On

While the device is off, fast press Fire Key 5 times in 2 seconds to turn it on. The screen successively displays the product logo and program version information, then enters the main interface.

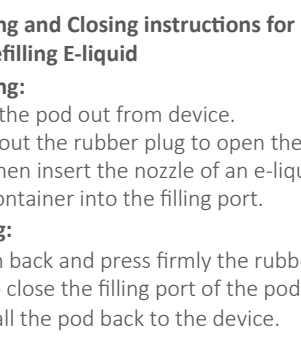

(Thallo)

(Thallo S)

English / 05

3. Vaping

While the device is on, press the Fire Key to vape (it will be forced to stop working when vaping is longer than 8 seconds, release and press again to vape again); Quickly press the Fire Key 3 times to lock or unlock the vaping function.

4. Screen Unlocked Status:

- (1) Press UP or DOWN Button to choose your desired wattage;
- (2) Press UP and DOWN button simultaneously to lock or unlock the wattage adjustment function;

5. Puff Setting

- (1) Press the Fire key and DOWN Button simultaneously to enter the "Clear Puff" interface then select YES to clear puff number.
- (2) The number of puffs will be automatically cleared when it reaches 200P.

6. Theme Color Setting

Press UP and DOWN Button simultaneously to switch the theme color in blue, green, red, yellow, purple and white.

7. Charging

When the USB cable is inserted, the charging interface will be displayed with battery percentage and estimated charge time.

8. Power Off

While the device is on, fast press Fire Key 5 times in 2 seconds to turn it off.

English / 06

Thallo / Thallo S Pod

Opening and Closing instructions for Filling and Refilling E-liquid

Opening:

1. Pull the pod out from device.
2. Pull out the rubber plug to open the filling port; then insert the nozzle of an e-liquid refill container into the filling port.

Closing:

3. Push back and press firmly the rubber plug to close the filling port of the pod.
4. Install the pod back to the device.

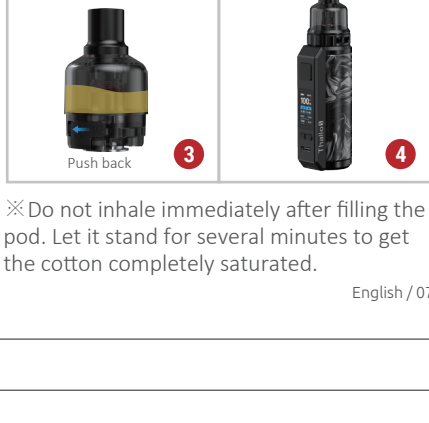

※ Do not inhale immediately after filling the pod. Let it stand for several minutes to get the cotton completely saturated.

English / 07

Opening and Closing Instructions for Replacing New Coil

1. Pull the coil head out of the pod.



2. Push the new coil head into the pod.



Control air input:

Rotate the adjustable airflow ring to control air input.



English / 08

Appendix 1 Key Function

Key	Function
Fire Key	Fast click 5 times in 2s- Power On/Off Fast click 3 times - Lock or unlock vape Function Hold on- Vape
UP	Click to increase the wattage
DOWN	Click to reduce the wattage
UP+DOWN	Lock or unlock the wattage adjustment function
Fire Key + UP	Adjust theme color
Fire Key + DOWN	Clear puff number

Appendix 2 Screen Prompts

Prompts	Details
BATTERY LOW	Before vaping: the battery voltage is lower than 3.3V±0.1V When vaping: the battery voltage is lower than 2.8V±0.1V(Thallo)/3.0V±0.1V(Thallo S).
OHMS TOO LOW	Resistance is higher than 0.15Ω±5%.
OHMS TOO HIGH	Resistance is lower than 2.5Ω±5%.
NO ATOMIZER	No pod is installed.
ATOMIZER SHORT	Short circuit has been detected.
PCBA TOO HOT	The temperature of PCBA is too high.
TIME OVER	Vaping time exceeds 8 seconds.
POWER LOCKED	The vaping function is locked (you can't fire it when locked)
WATTAGE LOCKED	The wattage adjustment function is locked (you can't change the wattage when pressing the UP/DOWN button)

English / 09

IMPORTANT SAFEGUARDS

Attention

Please read this manual carefully before using the product. Inappropriate use or handling of this product may be harmful.

- This product is only intended to be used as an e-cigarette, for the consumption of certain e-liquids. Do not use this product for any other purpose. This product is not designed to be a smoking cessation device.
- Please use the pod provided in this kit. Do not use pods of other brands with this kit.
- The suggested ratio of e-juice is 30% PG: 70% VG.
- Before using this product, please read carefully any information and instructions for safe use relating to the e-liquid which is vaped using this product.
- The SMOK product must not be offered for sale outside of, independently or separately to, the box or this leaflet.

Caution

- Handle this product with care at all times:
 - Avoid damage to the product's internal and external components.
 - Keep this product dry at all times. Do not immerse this product in water as the product is not waterproof. Do not immerse this product in corrosive or conductive solution as serious damage like short circuit may occur.
 - If you drop this product, make sure:
 - 1) the product is not broken, cracked or smashed;
 - 2) there is no leaking or leakage of e-liquid;
 - 3) components are not loose and have not come apart;
 - 4) the product functions normally and as intended;
 - 5) there is no damage to the mouthpiece.
 - Do not attempt to disassemble or assemble the product by yourself as damage or personal injury may occur.
 - Mechanical shock, extrusion, beating, or shaking to the device are strictly forbidden to prevent damage to circuit and battery cell.
 - Do not overcharge the batteries. If the batteries overheat do not use this product.

English / 10

- Charge the device indoors only;
- Do not place the product in a hot or humid environment.
- Do not expose your product to hot, cold, damp or direct sunlight.
- KEEP THIS PRODUCT OUT OF REACH OF CHILDREN.

• DO NOT use this product if:

- broken, leaking, if parts are cracked or deformed, or if the product has malfunctioned.
- abnormal heat occurs during vaping or charging. Do not overcharge the batteries.
- there is concerning leakage of e-liquid from the pod.
- conductive or corrosive liquids enter the device.
- there is any perceptible change in flavor of the e-liquid.
- where microbial contamination or other contamination is suspected.
- the pod is empty or almost empty. E-liquid should always be in the pod to avoid dry heating and burning the coil.
- THIS PRODUCT SHOULD BE SERVICED EVERY 6 MONTHS. If the product fails a service, do not use. Defective items and disposals must be replaced before re-use.
- Do not eat, drink, or smoke while using this product.
- The temperature for charging should be between 10 °C to 45 °C, temperature for using should be between 0 °C to 55 °C.
- Vaping products, including this product, should not be used in prohibited or restricted areas.
- Vaping products, including this product, should not be used in high oxygen environments.
- We recommend that you do not use vaping products, including this product, while driving.
- Using electronic cigarettes may create undesirable effects to you and the people around you.

• Store:

- Out of reach of children.
- Locked up.
- Separate and away from medical products and medication.
- In a ventilated and dry indoor environment at room temperature to avoid short circuit caused by touching with other metal materials.
- Well away from pets and animals.
- In the upright position, and secured to prevent falling over and leakage.
- Store in a dark and well-ventilated place below 30 °C.

English / 11

- Young people and non-smokers.
- Women that are pregnant or breastfeeding.



Instructions on servicing and disposal

- This product should be serviced every 6 months by a reputable e-cigarette dealer. Please retain a copy of your guarantee and provide dealers with the guarantee for servicing.
- If this product fails a service, is broken, or otherwise malfunctions: do not use this product, and dispose of this product appropriately.
- For disposal - Do not discard or dispose this product in general waste cabin, please follow the local law and regulations on battery recycling and disposal.

SAVE THESE INSTRUCTIONS!

English / 13

